

<b>Type of Course:</b>	<b>Graduate Studio + Research Workshop/Design Seminar</b>
M.Arch 2 <sup>nd</sup> yr:	ARCH 73100 Architecture Studio III (6 cr) + ARCH 73501 Research Workshop (3 cr)
M.Arch 3 <sup>rd</sup> yr:	ARCH 85100 Advanced Studio (6 cr) + ARCH 85200 Research Workshop (3 cr)
MS Arch:	ARCH 91102/93103 Advanced Studio (6 cr) + ARCH 91202 Design Seminar (3 cr)
<b>Class Meetings:</b>	<b>Workshop M 9:30-12:20; Studio M/TH 2:00-5:20pm</b>
<b>Office Hours:</b>	<b>Mondays 12p-2pm (Haferd); 15 hours for co-instructor (1/wk, TBD)</b>
<b>Instructor:</b>	<b>Professors Jerome Haferd, Najha Zigbi-Johnson</b>
<b>Location:</b>	<b>217</b>
<b>Semester/Year</b>	<b>Fall 2024</b>

## GENERAL DESCRIPTION

**STUDIO:** This advanced studio explores an architectural project through extended design research and in-depth building design propositions. Engaging with a variety of contemporary architectural design topics, students analyze and synthesize human, socio-cultural, contextual, technical, and regulatory forces. Project work includes quantitative investigation of environmental impacts and articulation of mitigation strategies. Independent research methodologies are supported, and student work is expected to achieve the quality of a well-developed architectural design thesis and design proposition.

**RESEARCH WORKSHOP:** This required seminar course focuses on special topics of study that support and broaden the design studio curriculum. Students co-enroll in this course with their architectural design studio.





*Oleleken Jeyfous, animated still, 2021*

**OVERVIEW : The Fall 2024 Graduate Studio+**

**Faculty :** lead, prof. Jerome Haferd, co-faculty, Najha Zigbi Johnson

**Consultants :** Kennedy Withers, AIA (historic preservation), Donovan Dunkley (mapping and visualization)

**Community Partners :** Maysles Documentary Center, Harlem Cultural Archive

The Fall Graduate Studio+, “Living Lenox”, will interrogate Lenox Avenue (Malcolm X Boulevard), engaging **seven sites** along the iconic Harlem corridor through the lens of Radical [Black] Preservation-as-speculative design project. The studio and workshop will be led by prof. Jerome Haferd, co-director of the Place, Memory, & Culture Incubator and prof. Najha Zigbi Johnson, editor of “Mapping Malcolm.” We will interpret the living tangible and intangible heritage of Lenox Avenue (between 116th and 135th) and these sites through : 1) acts of counter mapping, community engagement, 2) forensic analysis, counter-preservation and finally 3) detailed radical development + design projects. This studio is supported by the Harlem Place, Memory, & Culture Incubator at SSA.

Lenox Avenue, and this studio, are situated within the context of Harlem’s trans-historic positionality as a landscape of Black, African, and LatinX diaspora and heritage, a community and built environment that has always been subject to the forces of development/speculation, environment(al racism), material culture, and labor. Alongside collaborators Maysles Documentary Center, Kennedy Withers, Donovan Dunkley and others, the research and design projects will pair an understanding of this cultural heritage with a problematizing of how to conduct a speculative project of rebuilding, reimagining and rethinking through this moment of late stage capitalism in Harlem.

Working individually then in pairs, **students will choose one of the sites** to unearth the historic and existing environmental, cultural/historical, and architectural conditions of their respective lots, and translate this information into rich, compelling design projects. Each project will propose a development vision as well as an adaptive re-use, restoration, or re-imagination of their architectural artifact, surrounding street frontage and open space.

**Themes include :**

Resource Conservation / Embodied Energy

Black Aesthetics and Archives

Late Capitalist Architecture

Malcolm X and other cultural histories

Materiality, Ethics, Sustainability

Hyper programming / Black programming

Environment, Vegetation and Urban Heat

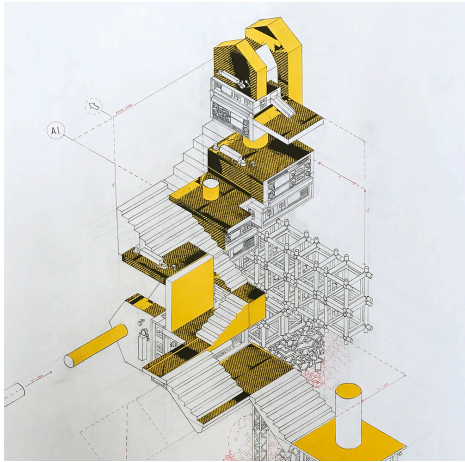

axonometric drawing, Oleleken Jeyfous

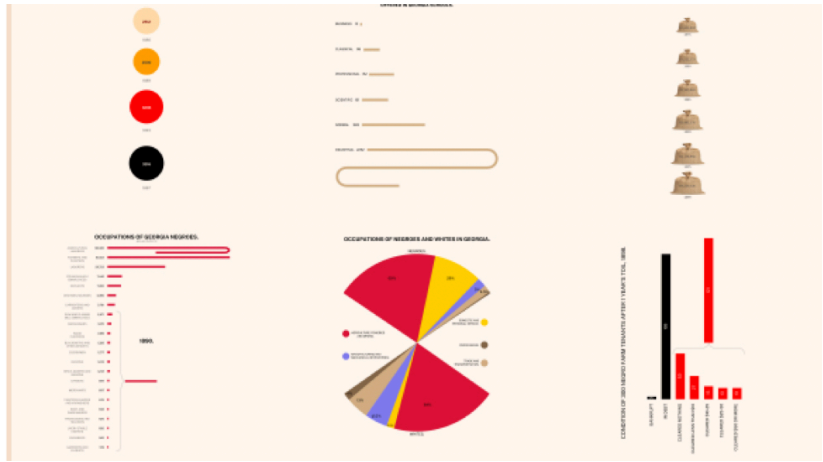

W. E. B. Du Bois's Data Portraits: Visualizing Black America, analytic infographics, 1900

## SPECIFIC DESCRIPTION

In the first part of the semester we will visualize and document these iconic and emblematic Harlem buildings/spaces? and constituent exterior public “fronts” in detailed, novel and unprecedented ways. In the second part of the semester we will evolve these detailed documents into speculative proposals that posit Black Radical Imaginations for their architectural, programmatic, ecological futures and even alternate past lives, and afterimages.

The **Research Seminar** portion of the course, led by prof. Zigbi Johnson, will introduce and investigate Lenox Avenue at the scale of the corridor and “the Block” through developing a **counter mapping practice**. Paired with contemporary and embedded, historical Harlem dialogue and research and working with **stakeholder interviews** along with **ArchGIS** and other contemporary visualization software/techniques, students will develop a robust countermap of Lenox Ave. and these sites that integrates rigorous and nontraditional forms of cultural information.

In the **Studio** students will engage [Black] Preservation analysis of their constituent sites and develop a language to represent the forensic, transhistorical information of each building and site past, present, and even future. Then, they will develop rich design projects which will motivate a theory of Radical Preservation and also address the themes of the course in speculative design proposals for each site.

**Seminar Week 1-4** - Introduction of the Corridor, 7 Sites, Historical-Theoretical Intro  
Mapping Workshop

**Studio Week 1-4** - Individual Sites Analysis / Zoom Maps  
Stakeholder Interviews

**Seminar Week 5-8** - Lenox Ave Countermap, Guest Lectures  
Visualization Workshops / Feedback Sessions, Lenox Ave. Map

**Studio Week 5-8** - Forensic Architectural Analysis and Initial Development Proposal  
Preservation Workshops / Feedback Sessions, Sites 1-7

**Midterm Review Seminar** - Lenox Ave Map w/ additional commentary

**Midterm Studio** - Individual Site Analyses , Initial Development Proposal

**Week 9-14 Seminar** - Development of Research Dossiers / TBC

**Week 9-14 Studio** - Development of Final Speculative Projects (drawings and models, etc.)

**Final Review Studio** - Maysles Documentary Center Exhibition TBC



*Section Perspective, Paul Rudolph, penthouse apartment, 23 Beekman Place, New York City. 1965*

## **SPECIFIC LEARNING OBJECTIVES**

### **Studio portion:**

Site Visits / Surveys - students will conduct in person site visits of Lenox Ave sites, surveying existing conditions of site and architectural characteristics.

Environmental Mapping / Analysis -

Historic Preservation and Analysis Workshops - co-led by Kennedy Withers

Archival and Community Partner Research - Students will also conduct archival research and work with community partners (Maysles documentary center film archive) to support their analysis of their respective sites' embodied energy and labor lifecycle as well as cultural and heritage / preservation status and significance. Deliverable - research dossier and interview recordings.

Deliverable - speculative design and development drawings, analysis, and mixed media exhibit materials

### **Research Workshop portion:**

Mapping Visualization Workshop and Exercise - co-led by consultant Donovan Dunkley, The site and archival research will help to inform several multi-scalar mapping workshops and exercises using Google, GIS (storymap and other features) and other visualization software to represent environmental, political, and social characteristics. Deliverable - Lenox Ave. Map and (7) Site Zoom Maps

Stakeholder interviews.

Deliverable - Lenox Block map, research dossier (booklet) and interview recordings

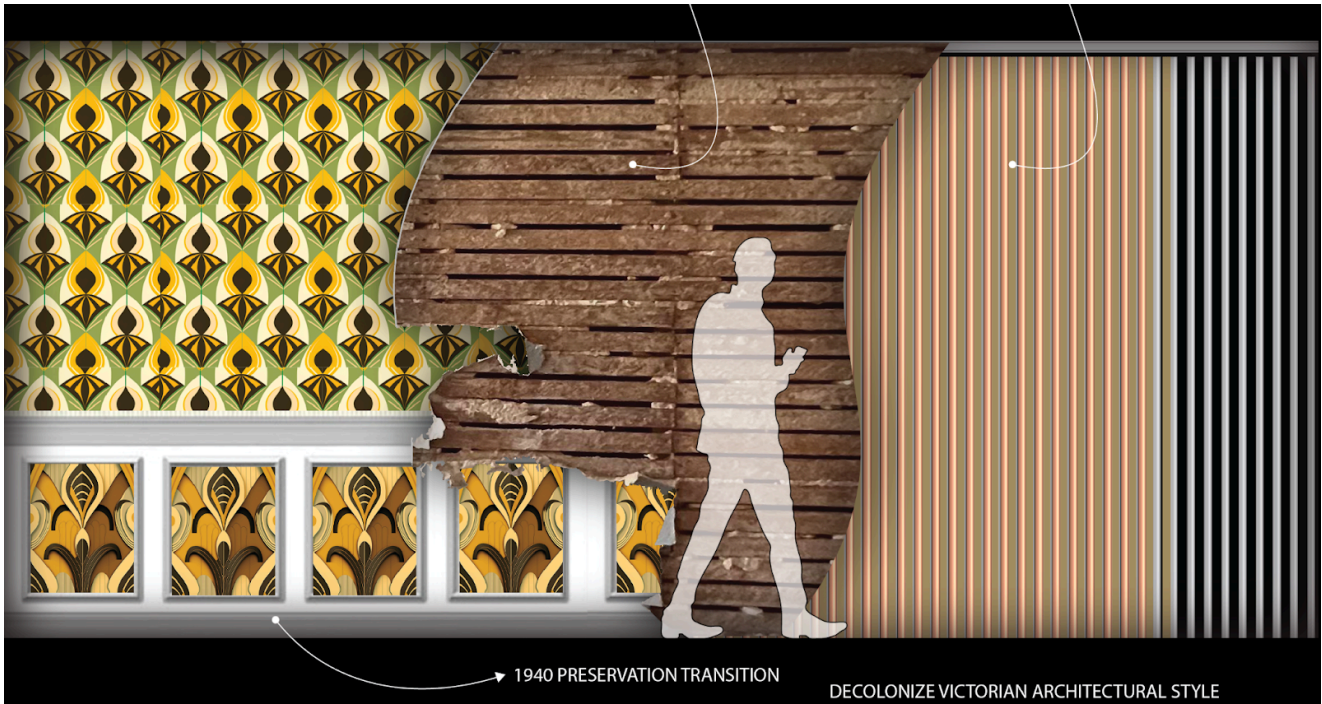

*Tesseracting the Opera House, wall experimental restoration study, Unit 24 : Marronage, Shadeen Dixon and Matthew Awai, CCNY SSA 2023*

**RESEARCH**

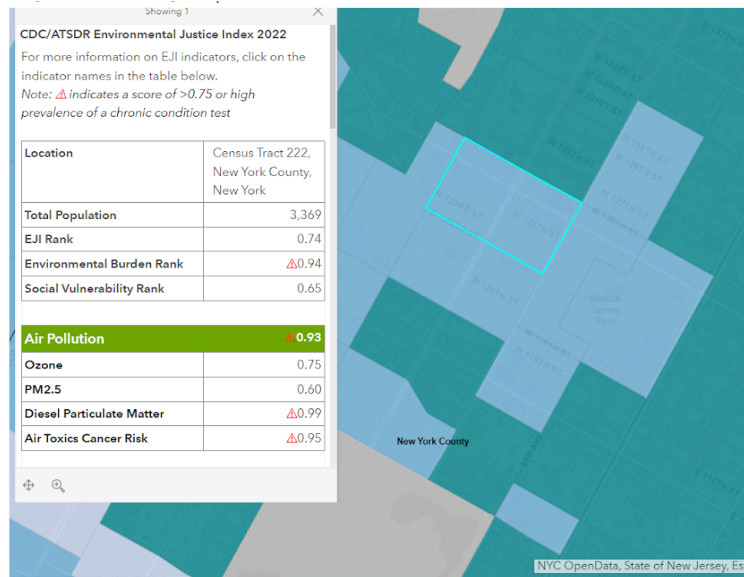

*Environmental Justice Index Map, GIS*

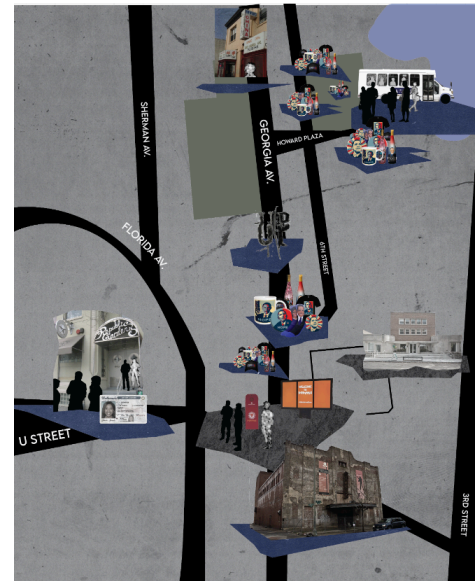

*"Old Howard" countermap, Fugitive Practice, 2021*

**Studio portion :**

[text forthcoming]

**Research Workshop portion :**

[text forthcoming]

## PROGRAM



Lenox Ave. corridor, Google Earth

Corridor Scale Mapping

Lot Scale Mapping + Development proposal

Architectural Scale Analysis + Preservation or Counter-preservation design proposal

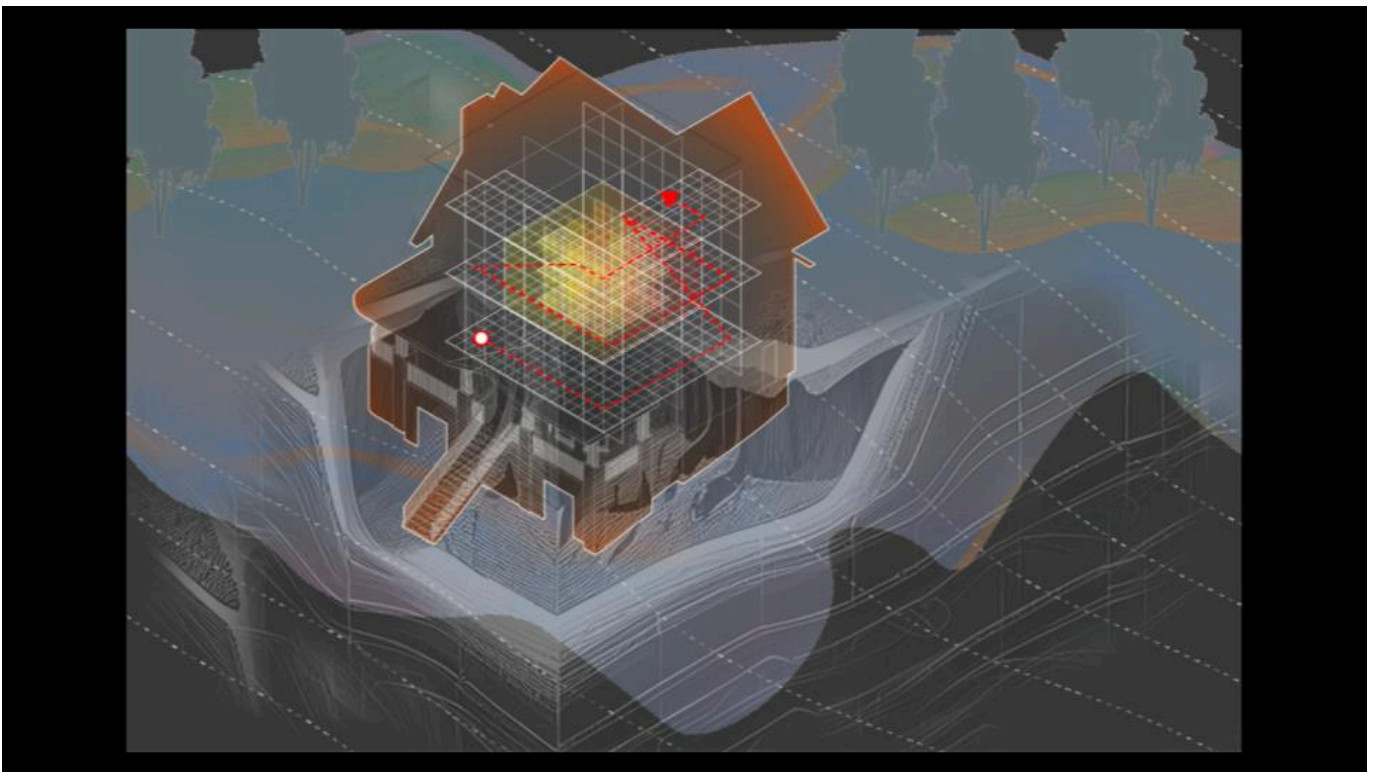

*Tesseracting the Opera House, wall experimental restoration study, Unit 24 : Marronage, Shadeen Dixon and Matthew Awai, CCNY SSA 2023*

**SITES (South to North)**



1. Schomberg / Speakerbox Corner
  - a. Stakeholder contact : TBC



2. Lenox Terrace (street frontage, destroyed)
  - a. Stakeholder contact : Najha Zigbi-Johnson or contact



3. 288 Malcolm X Boulevard (Lenox Lounge to Wells Fargo)

- a. Stakeholder contact : Michael Henry Adams



- 4. Whole Foods Site (corner of 125th / Lenox Ave.)

- a. Stakeholder contact :

- 5. Mt. Olivet Baptist Church (image on page 9)

- a. Stakeholder contact : Claudette Brady, Save Harlem Now



- 6. Owens Funeral home + Studio Zewde

- a. Stakeholder contact : Sara Zewde



- 7. Masjid Malcolm X (Shabazz mosque)

- a. Stakeholder contact : Shabazz Center



## READINGS / BIBLIOGRAPHY

- Fugitive Practice, Jerome Haferd & Curry J. Hackett
- Rethinking Education as the Practice of Freedom: Paulo Freire and the promise of critical pedagogy,
- Where is Africa Vol.1, Emanuel Admassu, Anita N. Bateman,
- Sites of Inscription: Writing In and Against Post-Plantation Geographies, Elleza Kelley
- Mapping Malcolm, Najha Zigbi-Johnson
- Black Counter Cartographies w/ Dr. Tonya Foster & Dr. Elleza Kelley ( Youtube lecture)
- The Geography of Malcolm X: Black Radicalism and the Remaking of American Space., James Tyler
- Demonic Grounds: Black Women And The Cartographies Of Struggle, Katherine McKittrick
- Abolition Geography: Essays Towards Liberation, Ruth Wilson Gilmore
- Racial urbanities: towards a global cartography, Giovanni Picker
- The mapping behind the movement: On recovering the critical cartographies of the African American Freedom Struggle, Derek H. Alderman, Joshua F.J. Inwood, Ethan Bottone
- NYC 1940's Map: [https://1940s.nyc/map/photo/nynyma\\_rec0040\\_1\\_01840\\_0153#14.21/40.79355/-73.96941](https://1940s.nyc/map/photo/nynyma_rec0040_1_01840_0153#14.21/40.79355/-73.96941)
- A Swarm of Bees in High Court, Tonya Foster



## FILMS TO SCREEN/WATCH

- Rezoning Harlem, The Battle Over Harlem's Future, 2008, Natasha Florentino & Tamara Gubernat
- "No Vietnamese call me N\*gger, 1968, David Loeb Weiss, documentary
- Homegoings (Owen's Funeral Home Documentary), 2013, Christine Turner

## REFERENCES

- <https://nymag.com/intelligencer/2017/07/harlem-gentrification-whole-foods-vanishing-new-york.html>
- <https://medium.com/@michaelhenryadams/last-call-whos-to-blame-for-destruction-of-the-lenox-lounge-240d7af25253>
- <https://www.homegoings.com/>



**WEEKLY SCHEDULE, M 9:30am-12:20pm, M/TH 2:00-5:20pm**

*Note: schedule below is subject to revision through the duration of the semester.*

		Research Workshop (morning)	Studio (afternoons)
<b>W1</b>			
Th	08.29	Syllabus overview / Introductory lecture? Exercise 01a assigned - The Block pt. 1	Convocation @ 2:00pm, Aaron Davis Hall Grad Studio Lottery @ 3:00pm, rm. 107 (Spitzer) Followed by first studio meeting Syllabus overview Exercise 01b assigned - The Block pt. 2
<b>W2</b>			
Mon	09.02	College Closed (Labor Day), no classes	
Th	09.05	no class	Hour SSA/JEDI Climate Survey (in studio) 2-3pm  Data Research ? Intro Lectures Pin- Up Exercise 01?  Workshop 1 - Mapping w/ Kennedy Withers
<b>W3</b>			
Mon	09.09	Site 1 and Site 2 Arturo Schomberg and Lenox Terrace  Workshop #2 - Visualization w/ Donovan pin-up Exercise 01a	Studio - Lenox Walking Tour op. 1 Maysles Visit - (screen ReZoning Harlem? could happen later lets see)
Th	09.12	no class	Studio

			<b>Sciame Lecture: Lawrence Vale</b>
<b>W4</b>			
Mon	09.16	How We Come to Know Space Site 3?  Workshop #3 - Visualization 2 w/ Donovan	Studio - Lenox Walking Tour op. 2 Maysles Visit - (screen ReZoning Harlem? could happen later lets see)
Th	09.19	no class	Studio <b>Rudin Lecture: Alan Hantman</b>
<b>W5</b>			
Mon	09.23	Workshop	Studio
Th	09.26	no class	Studio <b>Sciame Lecture: Maria Carrizosa</b>
<b>W6</b>			
Mon	09.30	Workshop	Choose Sites
Th	10.03		No Classes
<b>W7</b>			
Mon	10.07	Maysles Documentary ReZoning? / Workshop?	Individual Site Visits - Maysle's?
Th	10.10		Studio <b>Sciame Lecture: Jon Michael Schwarting &amp; Frances Campani</b>
<b>W8</b>			
Mon	10.14	College Closed (Columbus/Indigenous Peoples' Day), no classes	
Tu	10.15	Workshop (Classes for a Monday schedule)	Studio
Th	10.17		Studio <b>Sciame Lecture: Anna Pashynska &amp; Tania Pashynska</b>
<b>W9</b>			
Mon	10.21	Workshop	MID REVIEW op 1
Th	10.24		Studio - Midterm Reviews
<b>W10</b>			
Mon	10.28	Workshop	MID REVIEW op 2
Th	10.31		Mid-semester assessments
<b>W11</b>			
Mon	11.04	Workshop	Studio
Th	11.07		Studio
<b>W12</b>			
Mon	11.11	Workshop	<b>Grad Sharing Session</b> Studio
Th	11.14		Studio
<b>W13</b>			
Mon	11.18	Workshop	Studio
Th	11.21		Studio
<b>W14</b>			
Mon	11.25	Workshop	Studio
Th	11.28		College Closed (Thanksgiving), no classes
<b>W15</b>			
Mon	12.02	Workshop	Studio
Th	12.05		Studio

**FINAL REVIEWS, Dec 9-13**

Mon 9 Dec	Tues 10 Dec	Wed 11 Dec	Th 12 Dec	Fri 13 Dec
<b>Foundation</b>	<b>Foundation</b>	<b>Grad Studios</b>	<b>Grad Studios</b>	<b>Grad Studios</b>
Kirsimagi King	Kim	Salcedo Aydogan	Kuehl Ebo	<b>Haferd</b> Zhang

Mon/Tu 12.16 + 17      Clean-up Days (all materials, projects, and any other items must be removed from studio)  
 Tu 12.17              End of Semester Assessment (faculty only)

**FINALS**

Tu 12.17              Student Portfolios due for: SSA/CCNY Archive, etc. as directed by instructor  
 Fr 12.27              Final Grade Submission Deadline

**GRADING/ATTENDANCE POLICIES AND STUDIO CULTURE**

**Learning Outcomes:**

- To apply architecture research methods for testing and evaluating innovative approaches to design. (NAAB PC.5)
- To devise and develop a process for shaping the built environment through design. (NAAB PC.2)
- To successfully identify and integrate multiple factors into a design process, working in at least two scales. (NAAB PC.2)
- To demonstrate the ability to understand and synthesize user requirements, regulatory requirements, site conditions, and accessible design into a design project. (NAAB SC.5)
- To demonstrate the ability to consider the measurable environmental impacts of design decisions. (NAAB SC.5)

**Course Expectations:**

- That students will develop a high level of independent thought and rigor and a willingness to go beyond both basic project requirements and their own perceived limits and abilities.
- That students will successfully complete all project requirements. No make-up or postponed project submissions will be accepted except in the case of medical emergencies or other extraordinary circumstances. Excused absences and project delays must be officially cleared by professor in advance to be considered valid.

**Community Agreement:**

- As noted on the schedule, the professor will make time for an *Hour SSA* session for a supportive open discussion among students.
- Studio members will work *together* to create a community agreement for interacting together over the semester. Definition: "A consensus on what every person in our group needs from each other and commits to each other in order to feel safe, supported, open, productive and trusting... so that we can do our best work." <https://www.nationalequityproject.org/tools/developing-community-agreements>
- *Hour SSA* will be repeated at the middle of the semester.

**Methods of Assessment:**

- [TB]

**Grading Assessment:**

- [CUSTOMIZE]
- **Attendance:** Consistent level of preparation and on-time presence for each studio class and scheduled evening lectures.
- **Portfolio:** Completion of final portfolio or collection of studio work as directed by instructor and attendance at all scheduled portfolio related events.

[ASSIGNMENT]	XX%	[ASSIGNMENT]	XX%
[ASSIGNMENT]	XX%	[ASSIGNMENT]	XX%
[ASSIGNMENT]	XX%	[ASSIGNMENT]	XX%
Participation & Attendance	10%	Participation & Attendance	10%
Final Portfolio - completion & submission	5%	Final Portfolio - completion & submission	5%

- A (+/-)** Work meets all requirements and exceeds them. Presentations are virtually flawless, complete, and finely detailed. Work exhibits professional, “museum quality” level of craft. Student has developed an individual design process that shows a high level of independent thought and rigor. Work shows evidence of intense ambition and effort to go beyond expectations, and beyond the student’s own perceived limits of their abilities.
- B (+/-)** Work meets all requirements. Presentations are complete and finely detailed. Work exhibits professional level of craft. Student has developed an individual design process that shows a high level of independent thought and rigor.
- C (+)** Work meets minimum requirements. Deadlines are missed. While presentations may be somewhat complete, student has struggled to develop an individual design process and/or is lacking in craft or design resolution.
- F** Work is below minimum requirements. Student does not develop adequate design process, and/or does not finish work.
- INC** Grades of “incomplete” are not given under any circumstances unless there is evidence of a medical or personal emergency. In such cases, instructor and student develop a contract to complete work by a specified date, as per CCNY policy. Classes and/or work missed due to illness must be explained with a physician’s note.

**Notes:**

C is the lowest passing grade for M. Arch I and M.S. Arch students. No C- or D grades may be given to graduate students.

Working in teams does not guarantee the same grade for each team member; grades are based on a range of criteria for each individual student.

For more information on grading guidelines and other CCNY policies and procedures, consult the current CCNY academic bulletins: <https://www.ccny.cuny.edu/registrar/bulletins>

**Office Hours:**

Each studio/unit faculty member schedules regular office hours over the semester, as posted at the top of the syllabus. If a student needs to speak in private with a studio/unit critic, they should ask or email in advance to request a specific meeting time. Students may seek office hour appointments to discuss any matters of concern including personal, private matters and general inquiries about course related work, grading, assessment and content.

**Probation & Dismissal:** for program specific information related to grades, academic standing, probation and dismissal, please see your program academic advisor:

Graduate: Hannah Borgeson [hborgeson@ccny.cuny.edu](mailto:hborgeson@ccny.cuny.edu)

**Studio Culture:**

Working collaboratively and respectfully on studio assignments, with and alongside others, is an expectation in studio. Studio culture is an important part of an architectural education, and it extends to expectations for Faculty and the School’s Administration as well. Please see the Spitzer School of Architecture Learning, Teaching, and

School Culture Guidelines, which can be accessed on the SSA website here:  
<https://ssa.ccnycuny.edu/about/policies/>.

**Absence & Lateness:**

Arriving more than ten minutes late to class will constitute an absence. Two unexcused absences will result in a whole letter grade deduction from a final grade; more than four will result in a failing grade. It is expected that all students will participate in all scheduled working, midterm and final reviews and contribute constructively to the discussions.

**Absences due to Religious Observances:**

Students who will miss any class sessions, exams, presentations, trips, or the like due to a religious observance should notify the instructor at the beginning of the semester so that appropriate adjustments for observance needs can be implemented. This could include an opportunity to make up any examination, study, or work requirement that is missed because of an absence due to a religious observance on any particular day or days.

**Readings & Journals:**

Students are expected to keep a journal or sketchbook throughout the duration of studio to document their thought process & take notes of any texts, books, terms or references that are mentioned by either the studio critic or fellow classmates and to selectively follow up on these and any other assigned readings before the next class.

**Academic Integrity:**

As a student you are expected to conduct yourself in a manner that reflects the ethical ideas of the profession of architecture. Any act of academic dishonesty not only raises questions about an individual's fitness to practice architecture, but also demeans the academic environment in which it occurred. Giving or receiving aid in examinations, and plagiarism are a violation of an assumed trust between the school and the student.

Plagiarism, i.e. the presentation as one's own work of words, drawings, ideas and opinions of someone else, is as serious an instance of academic dishonesty in this context as cheating on examinations. The submission of any piece of work (written, drawn, built, or photocopied) is assumed by the school to guarantee that the thoughts and expressions in it are literally the student's own, executed by the student. All assignments must be the student's original work. Any copying, even short excerpts, from another book, article, or Internet source, published or unpublished, without proper attribution will result in automatic failure of the entire course.

The CCNY Academic Integrity Policy: <https://www.ccnycuny.edu/about/integrity>

For citations, the Chicago Manual of Style is recommended:  
[http://www.chicagomanualofstyle.org/tools\\_citationguide.html](http://www.chicagomanualofstyle.org/tools_citationguide.html)

**AccessAbility Center (Student Disability Services):**

The AccessAbility center (AAC) facilitates equal access and coordinates reasonable accommodations, academic adjustments, and support services for City College students with disabilities while preserving the integrity of academic standards. Students who have self-identified with AAC to receive accommodations should inform the instructor at the beginning of the semester. (North Academic Center 1/218; 212-650-5913 or 212-650-6910 for TTY/TTD). For further information, go to <http://www.ccnycuny.edu/accessability/> or email [disabilityservices@ccny.cuny.edu](mailto:disabilityservices@ccny.cuny.edu)

**Health And Wellness Support:**

City College's Office of Health and Wellness Services offers free and confidential counseling. Contact: Health and Wellness Services, Marshak Science Building, room J-15: [counseling@ccny.cuny.edu](mailto:counseling@ccny.cuny.edu).

**Gender Based Violence Resources**

City College has resources to support you if you have experienced sexual violence, intimate partner/domestic violence, gender-based discrimination, harassment or stalking. For confidential support, you can contact the Student Psychological Counselor: Confidential Advocate at (212) 650-8905 or the Gender Resources Program at (212) 650-8222. If you would like to report sexual misconduct, you can contact the Chief Diversity Officer and Title IX Coordinator, Diana Cuozzo, at 212-650- 7330 or [dcuozzo@ccny.cuny.edu](mailto:dcuozzo@ccny.cuny.edu). If there is an emergency on campus, you can call Public Safety at 212-650-777 and off campus call 911. <https://www.ccnycuny.edu/affirmativeaction>

**Library:**

The school's library is a shared resource that is necessary supplement to all research and design work. Please direct questions to the library staff or the Architecture Librarian Nilda Sanchez-Rodriguez:

[nsanchez@ccny.cuny.edu](mailto:nsanchez@ccny.cuny.edu)

**NAAB (National Architectural Accrediting Board)**

The National Architectural Accrediting Board (NAAB) is the sole agency authorized to accredit US professional degree programs in architecture. Since most state registration boards in the United States require any applicant for licensure to have graduated from a NAAB-accredited program, obtaining such a degree is an essential aspect of preparing for the professional practice of architecture. While graduation from a NAAB-accredited program does not assure registration, the accrediting process is intended to verify that each accredited program substantially meets those standards that, as a whole, comprise an appropriate education for an architect.

More specifically, the NAAB requires an accredited program to produce graduates who: are competent in a range of intellectual, spatial, technical, and interpersonal skills; understand the historical, socio-cultural, and environmental context of architecture; are able to solve architectural design problems, including the integration of technical systems and health and safety requirements; and comprehend architects' roles and responsibilities in society.

*Students should consult the NAAB website [www.naab.org](http://www.naab.org) for additional information regarding student performance criteria and all other conditions for accreditation.*

**NAAB CRITERIA ADDRESSED ([2020 Conditions for Accreditation](#))**

**PC.2 Design**—how the program instills in students the role of the design process in shaping the built environment and conveys the methods by which design processes integrate multiple factors, in different settings and scales of development, from buildings to cities.

**PC.5 Research & Innovation**—How the program prepares students to engage and participate in architectural research to test and evaluate innovations in the field.

**SC.5 Design Synthesis**—how the program ensures that students develop the ability to make design decisions within architectural projects while demonstrating synthesis of user requirements, regulatory requirements, site conditions, and accessible design, and consideration of the measurable environmental impacts of their design decisions.

**CONTACT INFORMATION:****Professors:**

Jerome Haferd [jhaferd@ccny.cuny.edu](mailto:jhaferd@ccny.cuny.edu)

Najha Zigbi-Johnson [nzigbijohnson@ccny.cuny.edu](mailto:nzigbijohnson@ccny.cuny.edu)